

Installation Guide for Beam Magnetic Dual Mode Antenna (Lightweight) (RST250)

Applications

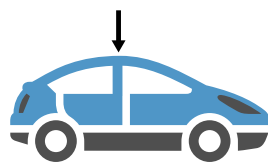

CAR

Recommended Antenna Installation location

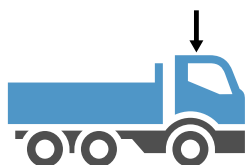

TRUCK

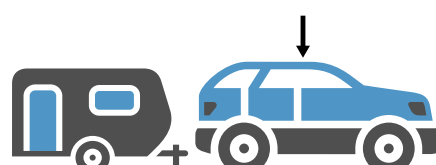

CARAVAN

Antenna installation is critical for optimum performance of your Iridium service.

Installation Guidelines

To ensure maximum performance of the antenna system and to maximise availability and reliability of service the antenna must;

- mount antenna horizontally (top side facing up)
- have a clear line of site to the sky
- be clear and free of obstructions
- be located away from other transmitting devices
- be securely attached to a flat ferrous surface
- be located outdoors
- be installed with a Beam certified cable

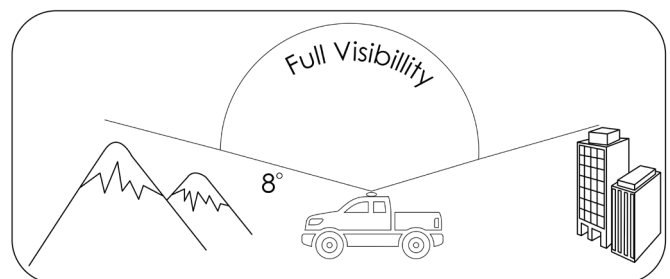

Installing Antenna Cables

When installing antenna cables, follow these guidelines:

- Route and restrain cables to prevent them from vibrating or moving under normal conditions, which could result in damage to the antenna or the coaxial cable connections.
- Wherever the cables contact structures, protect the cables from chafing or abrasion. If a cable needs to be bent, avoid kinking it, and ensure that each bend radius follow the cable specification limits.

Package Contents

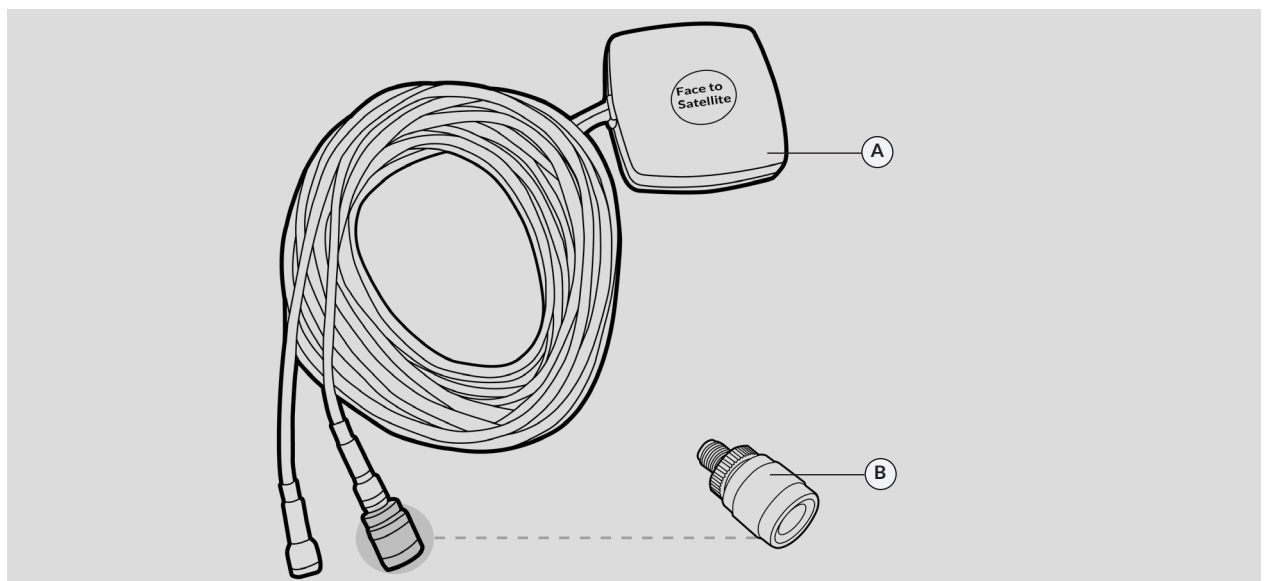

A - Dual Mode Antenna (includes 5 m / 16.4 ft Cable)

B - SMA to TNC Adapter

Antenna Installation

1. Choose the appropriate location for the antenna (front or back, depending on the placement of your Beam Iridium terminal or accessory). Recommended location is on a ferrous surface of the vehicle away from roof racks or other antennas, where the antenna can be on a flat and clean surface.

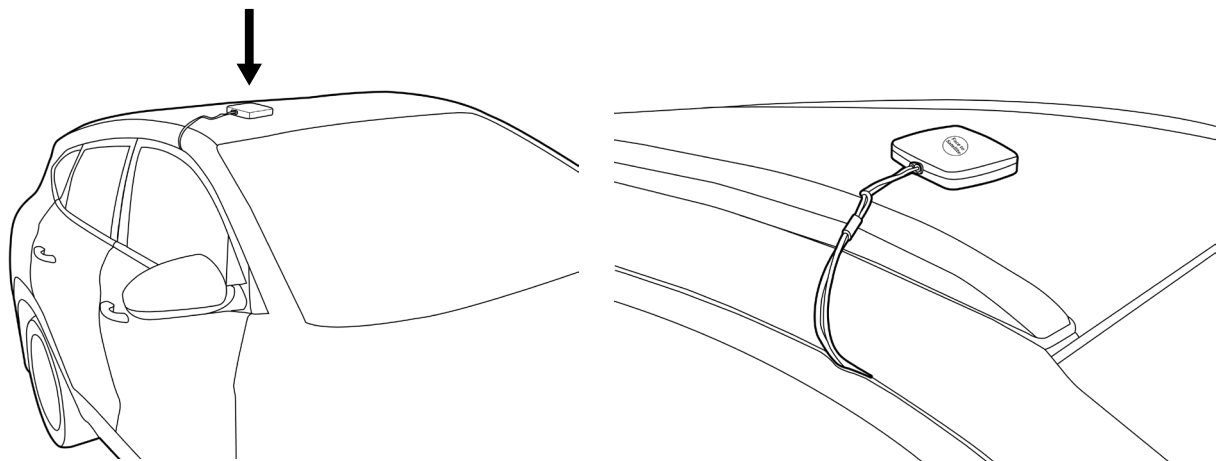

2. Route the cables through the door's rubber seal, not through the window. The rubber seal is soft which can create a seal around the cable preventing water from leaking into the cabin. At the same time, the soft rubber will not crush the cable.

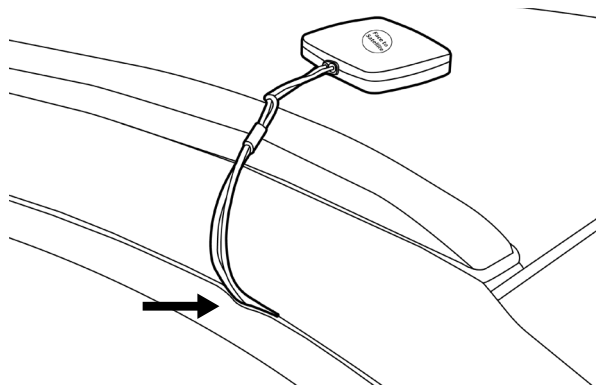

3. Route the cables inside the vehicle cabin and connect to the Iridium Accessory or Terminal, ensure that the GPS and Iridium connectors are attached to the corresponding connectors on the device.

4. To remove the antenna, avoid pulling the cable, instead hold the antenna as shown with one hand and pull antenna up from the metal surface. Do not slide across to avoid scratching the surface.

